



GENERAL PRODUCT SHEET

Pump Out SCC – Stage Cementing Collar

PRODUCT DESCRIPTION:

The Pump Out Stage Cementing Collar (SCC) is a device that provides a selective communication path inside the casing to the annulus without requiring any drill out. It contains a shifting inner sleeve operated by internal hydraulic pressure. Once the opening pressure is reached, the sleeve shifts into the open position exposing ports to allow for stage cementing. A closing plug following the stage cement lands in the Pump Out SCC and closes the ports permanently. Increasing pressure shears the internal components out of the Pump Out SCC allowing them to follow to the bottom of the casing string without requiring any drilling.

PROVIDE SOLUTIONS FOR:

- Off-bottom cement jobs
- Stage cementing in production casing
- Isolate loss circulation zones in harsh environments
- Vertical wells and minimizing rig time

FEATURES:

- Cementing ports open with internal pressure
- Shear out components that fall to bottom without drilling

BENEFITS:

- Provide cement integrity
- No drill out required to bring well onto production
- Reliable sealing and locking feature

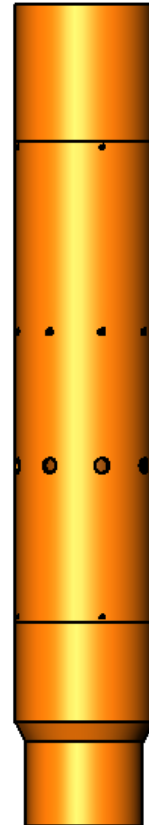

**GENERAL PRODUCT SHEET****Pump Out SCC – Stage Cementing Collar****700-PUMP OUT SCC – 7.00” STAGE CEMENTING COLLAR**

Dimensional and Engineering Data		
Overall Length	49.30 in	1.25 m
OD (Nominal)	8.25 in	210 mm
Thread Configuration	Box X Pin	
Opening Pressure	500-4,000 psi	35-276 bar
Shear Out Pressure	1,500-4,000 psi	103-278 bar
Minimum Flow Area	4.81 sq. in	3,103 sq. mm
Maximum Temperature Rating	250°F	122°C