



GENERAL PRODUCT SHEET

TAM TAP-OUT™

Composite Hydraulic Port Collar – Casing to Annulus Selective Communication Path Tool

PRODUCT DESCRIPTION:

The patented TAM Hydraulic Port Collar (HPC) was developed to reduce rig time for two stage or off bottom cementing. Unlike conventional stage tools that must be drilled out, the TAM HPC is designed to hydraulically shear out the seat and wiper plug once the stage cementing is complete. This eliminates drilling out, which improves pressure integrity reliability after closing. The seat and wiper plug are made of composite material and designed to shear out after closing the sleeve and pushed to bottom to be drilled up.

The tool opens hydraulically by pressuring up against the primary cement plug or by dropping a ball or cone to a shut-off baffle. A wide range of opening pressures allows flexible use with other hydraulically operated devices such as TAM's Casing Annulus Packer. For off bottom cement jobs with slotted liner, a shut-off seat with float is available for well control.

Once the cement has been displaced, the wiper plug lands on the shear out seat and pushes the sleeve down to a latched in position. Additional pressure is applied to shear the seat, leaving no restriction.

PROVIDE SOLUTIONS FOR:

- Two-stage cementing
- Two-stage cementing with Casing Annulus Packers
- Off bottom cementing with slotted liners

FEATURES:

- Opens hydraulically, no opening cone required
- Hydraulic open feature allows to be run in high deviations
- Reliable seal that maintains pressure integrity after high pressure unloads
- No drill out required
- No restrictions after shearing out seats
- ID after shear out is greater than drift
- Reliable latch ring

BENEFITS:

- Reduce rig time in stage cementing operations by eliminating drill out
- No opening cone required providing additional savings in material and time
- Increase in pressure integrity after closing with the elimination of drilling in the ID
- Burst meets or exceeds casing

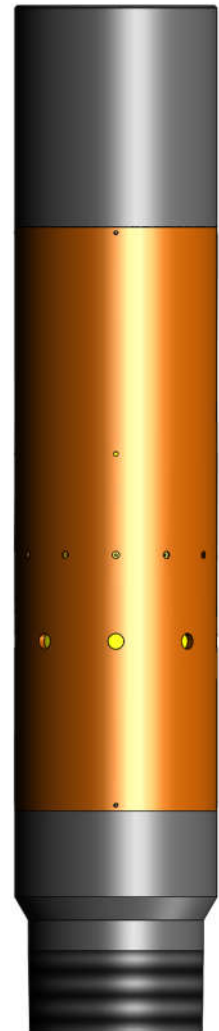



TAM INTERNATIONAL

GENERAL PRODUCT SHEET

Composite Hydraulic Port Collar – Casing to Annulus Selective Communication Path Tool

TOOL SPECIFICATIONS:

Casing OD	Weight	Grade	Product OD	Product ID	Closing Seat ID	Length	Tensile (1)	Burst	Collapse	Opening Pressure	Seat Shear Out Pressure (2)	Cancellation Pressure
7	20-26	L80	8.25	6.366	5.25	56.8	548,000	7240	5410	594 - 7128	1858	929
7	29-32	L-80	8.25	6.074	5.25	56.8	661,000	9060	8600	594 - 7128	1858	929
7.63	26.4-29.7	P110	8.91	6.86	5.88	56.8	940,000	7230	5660	525 - 6300	1589	795
8.63	28-32	L80	10.25	7.907	6.89	56.8	732,000	5710	4540	448 - 5376	1163	582
9.63 (3)	40 - 47	L80	11.13	8.765	7.75	56.8	892,000	6870	4750	415 - 4980	948	474
10.75	40.5 – 45.5	L80	12.9	9.909	8.86	56.8	1,041,000	6430	5070	363 - 4356	740	370
13.375	54.5 - 68	L80	15.4	12.415	11.46	56.8	1,214,000	4650	2840	298 - 3576	467	234

- 1- The tensile is related to internal threads of the tool. 1-12 Pins
- 2- The ultimate seat shear out value is the pressure that must exceed circulation pressure at plug bump. Fixed
- 3- ISO-14998 V3, Q3 Qualified 12 pins

*** All HPC -TAP OUT have 4.8 in² flow area – 8ea cementing ports 7/8” diameter